

Vero Washbasin, furniture washbasin # 045460..00 /
045460..30 / 045460..60

| < 600 mm > |

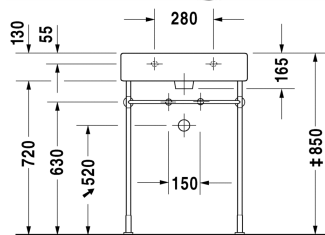
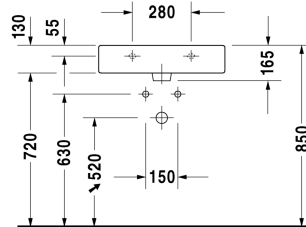
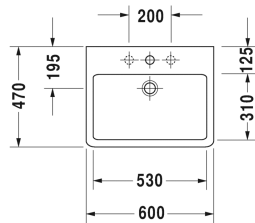

Washbasin, furniture washbasin	Dimension	Weight	Order number
with tap platform, underneath glazed, 600 mm			
Colors			
00 White Alpin 08 Black			
Variant			
● with overflow	600 x 470 mm	17.900 kilogram	045460..00
●●● with overflow	600 x 470 mm	17.900 kilogram	045460..30
☒ with overflow	600 x 470 mm	17.900 kilogram	045460..60
Sanitary ceramics with the special WonderGliss surface finish will remain clean and attractive-looking for a long time to come. When ordering WonderGliss please add a "1" as eleventh digit to the model number.			
Accessory for ceramics			
Push-open waste for washbasins with overflow		0.400 kilogram	005052
Accessory			
Towel rail square tube 14 mm, for washbasin # 045460, 235060, 235360, 235660	550 mm	0.500 kilogram	003037
Design Siphon		1.500 kilogram	005036
Suitable products			
Metal console height adjustable +50 mm, for washbasin # 045360, 045460, 235060,			003063
Vanity unit wall-mounted 1 pull-out compartment, for Vero # 045460, 550 x 440 mm	550 x 440 mm		KT6686

**Vero Washbasin, furniture washbasin # 045460..00 /
045460..30 / 045460..60**

|< 600 mm >|

Vanity unit wall-mounted 2 drawers, upper drawer including cut-out for siphon and siphon cover, for Vero # 045460, 550 x 440 mm	550 x 440 mm	KT6636
Vanity unit wall-mounted 1 pull-out compartment, compartment consists of glass dividers and 2 boxes (small/large), for Vero # 045360, 045460, 550 x 443 mm	550 x 443 mm	XL6044
Vanity unit wall-mounted 2 drawers, upper drawer including cut-out for siphon and siphon cover, for Vero # 045360, 045460, 550 x 443 mm	550 x 443 mm	XL6344
Vanity unit wall-mounted 1 opened compartment including towel rail, for Vero # 045460, 550 x 431 mm	550 x 431 mm	VE6004
Vanity unit wall-mounted 1 pull-out compartment, pull-out compartment including cut-out for siphon and siphon cover, for Vero # 045460, 550 x 431 mm	550 x 431 mm	VE6104
Vanity unit wall-mounted 2 drawers, upper drawer including cut-out for siphon and siphon cover, for Vero # 045460, 550 x 431 mm	550 x 431 mm	VE6204

All drawings contain the necessary measurements which are subject to standard tolerances. They are stated in mm and are non-binding. Exact measurements, in particular for customised installation scenarios, can only be taken from the finished piece.